



HURRICANE CABLE BLOWING

NEW

HURRICANE

The Hurricane has been designed to maximize protection for micro cables with a compliant double drive concept, backed by the latest technology in servo controls to provide precise control of torque and speed. Single person operation with safe, easy to operate ergonomic controls combines with low maintenance and high reliability to form the machine's key features.



- Cable Size: 2.5-14mm
- Duct Size: 5-25mm
- Pushing Force: 90 lbs.
- Advanced Data Logging

Main Features

- Dual Digital servo motor drive system
- Advanced data logging system measures speed, force, distance, GPS location and environmental conditions
- Forward and reverse
- Installs an Industry leading range of cables with one machine
- Automatic Cable centralizing
- Synchronous high grip profiled compliant drive belts
- Vertical design with ergonomic controls for ease of operation
- Variable torque and speed controls via remote
- Single person operation
- Digital cable speed and length monitoring
- Auto stop facility when air stone fitted
- Integral air valve and pressure gauge
- Easy cable threading
- Polycarbonate safety guarding
- Lightweight and compact
- Low maintenance
- Low noise levels
- Travel case
- Tool Kit

SPECIFICATIONS

OPERATING CAPACITIES

Pushing Force: 0-95 lbs. (0-422N)
Pushing Speed: 0-279 ft/min (85m/min)
Cable Size: .10-.55" (2.5-14mm) O.D.
Sub – Duct Size: .20-.98" SDR (5-25mm) O.D.

DIMENSIONS

Weight: 53 lbs. (24kg)
Weight with case and power supply: 113.5 lbs. (51.5kg)
Dimensions (ht x length x width): 13 7/8" x 21 7/8" x 12"
 352mm x 556mm x 305mm

PNEUMATIC SYSTEM

Air Hose Bore (min):
Operating Pressure: 220 psi (15 bar)S
Flow: The air supply should be filtered, cooled and dry

POWER REQUIREMENTS

90-264VAC 50/60 Hz

ORDERING INFORMATION

P/N	DESCRIPTION	Weight
90000	Hurricane Cable Blowing Machine	53 lbs

TOOLS BUILT TO GO THE DISTANCE



HURRICANE CONFIGURATION

With the purchase of the Hurricane you'll get the Blowing Machine, Controller, Power Supply, Heavy Duty Case with wheels, Toolkit and 1 set of collets and seals). Please select from the following:

- (A) - 1 size of Duct Clamp and Seal kit (This is for your duct O.D. size)
- (B) - 1 size of cable seals (this is for your fiber O.D. size)
- (C) - 1 size of cable guide (this is for your fiber O.D. size)
- 3-11mm drive belt (other sizes ordered separately)

A

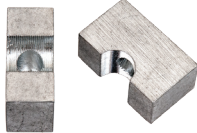

DUCT CLAMP AND SEAL KIT

P/N	Description
90006	5MM DUCT
90007	7MM DUCT
90008	8MM DUCT
90049	8.5MM DUCT
90009	10MM DUCT
90010	12MM DUCT
90050	12.7MM DUCT
90011	14MM DUCT
90012	16MM DUCT
90013	18MM DUCT
90014	20MM DUCT
90051	*21.6MM DUCT
90016	25MM DUCT

**21.6mm may be referenced as a 22mm*

B



CABLE SEALS

P/N	Description
90022	2.5-3MM
90023	3-4MM
90024	4-5MM
90025	5-6MM
90026	6-7.5MM
90027	7.5-9MM
90028	9-10.5MM
90029	10.5-12MM
90030	12-14MM

REPLACEMENT DUCT SEALS



P/N	Description
90032	5MM DUCT
90033	7MM DUCT
90034	8MM DUCT
90046	8.5MM DUCT
90035	10MM DUCT
90036	12MM DUCT
90047	12.7MM DUCT
90037	14MM DUCT
90038	16MM DUCT
90039	18MM DUCT
90040	20MM DUCT
90048	21.6MM DUCT
90041	22MM DUCT
90042	25MM DUCT

C



CABLE GUIDE KIT

P/N	Description
90017	2.5-4MM
90018	4-6MM
90019	6-9MM
90020	9-12MM
90021	12-14MM

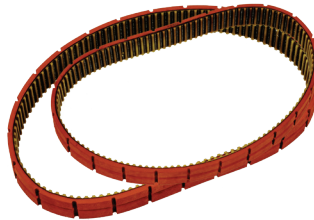

DRIVE BELT ASSEMBLIES

P/N	Description
90043	2.5-9MM (ORDERED SEPARATELY)
90044	3-11MM (SUPPLIED & INSTALLED)
90045	5-14MM (ORDERED SEPARATELY)

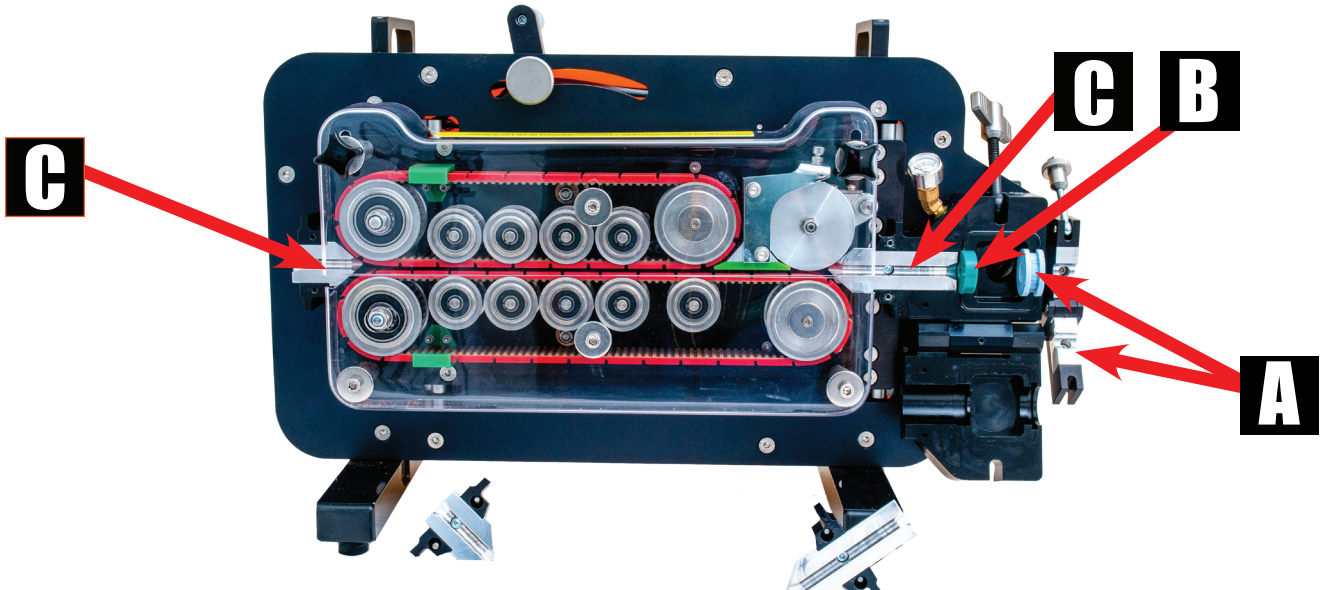

TOOLS BUILT TO GO THE DISTANCE