

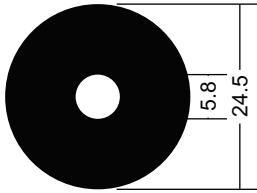

Tornado Cable Seal Identification Chart

Place seal over drawing to find match.

Note: If printing to use as template, choose "actual size" in print dialog box



89085
 .23-.29" (6-7.5 mm)
 1 Green Line 

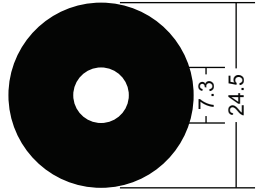

89086
 .29-.35" (7.5-9.0 mm)
 2 Green Lines 

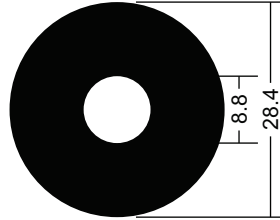

89087
 .35-.41" (9-10.5 mm)
 1 Purple Line 

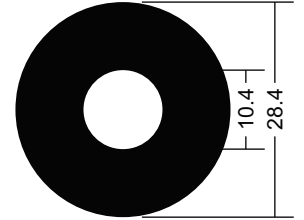

89088
 .41-.47" (10.5-12.0 mm)
 2 Purple Lines 

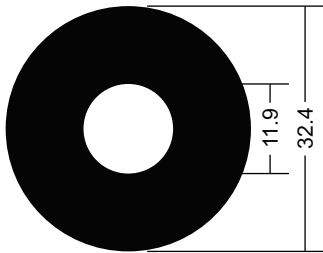

89093
 .47-.55" (12-14 mm)
 1 Silver Line 

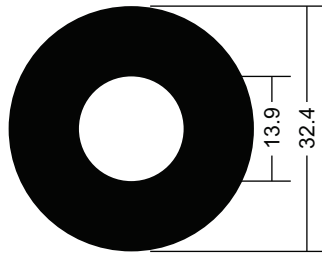

89094
 .55-.63" (14-16 mm)
 2 Silver Lines 

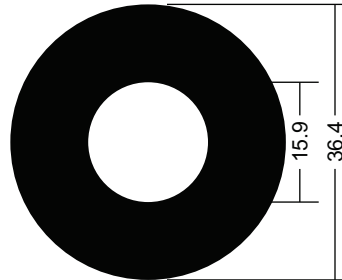

89095
 .63-.71" (16-18 mm)
 1 Gold Line 

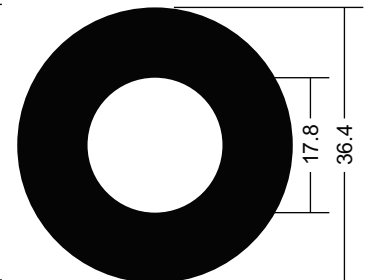

89096
 .71-.79" (18-20 mm)
 2 Gold Lines 

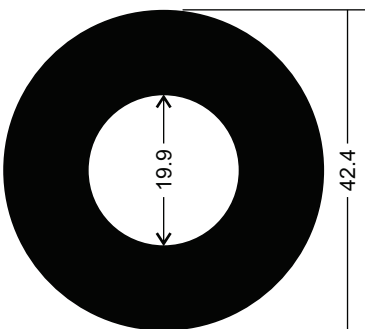

89103
 .79-.87" (20-22 mm)
 1 Blue Line 

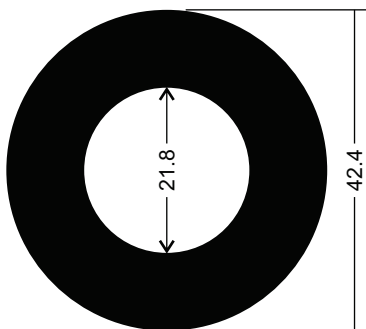

89104
 .87-.95" (22-24 mm)
 2 Blue Lines 

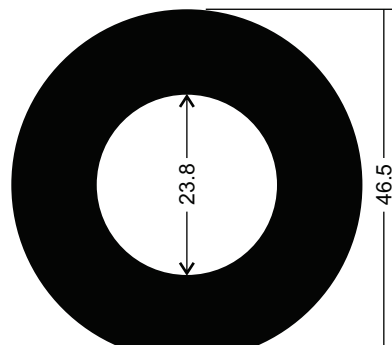

89105
 .95-1.02" (24-26 mm)
 1 Red Line 

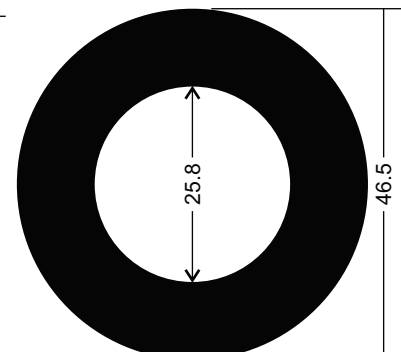

89106
 1.02-1.10" (26-28 mm)
 2 Red Lines 